

CLEAN STEAM TRAP (CST-30)

TECHNICAL INFORMATION SHEET

STAINLESS STEEL (SS 316L)

SIZE : 15NB TO 25NB



DESCRIPTION

Volfram Clean Steam Trap (CST-30) are available with stainless steel (SS 316L) material. These clean steam trap are best suited for use in clean steam system. The standard heating element exhibits high sensitivity to variations in condensate temperature and is engineered to initiate opening with minimal sub-cooling below the respected saturation curve. Additionally, this element contributes to optimal performance and seamless functionality within clean steam systems.



CLEAN STEAM TRAP (CST-30)

SIZES & CLASS / RATINGS

- Available Sizes : 15 NB, 20 NB, 25 NB.
- Available Class / Rating : #150
- End Connection : Tri Clover

DIMENSIONS(MM) AND WEIGHT

| Parameters | Size | | |
|---------------|--------|--------|-------|
| | 15 NB | 20 NB | 25 NB |
| A | 60 | 60 | 60 |
| B | 90 | 90 | 90 |
| C | 105 | 105 | 105 |
| APPROX WEIGHT | 0.8 KG | 0.8 KG | 1 KG |

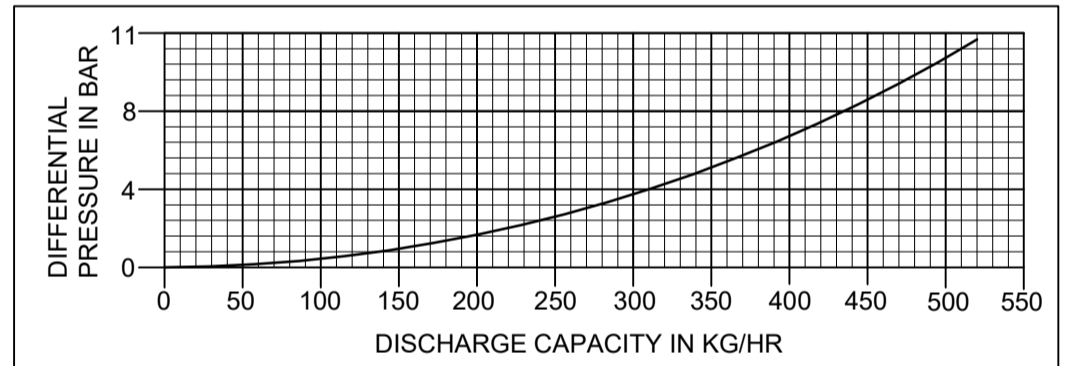
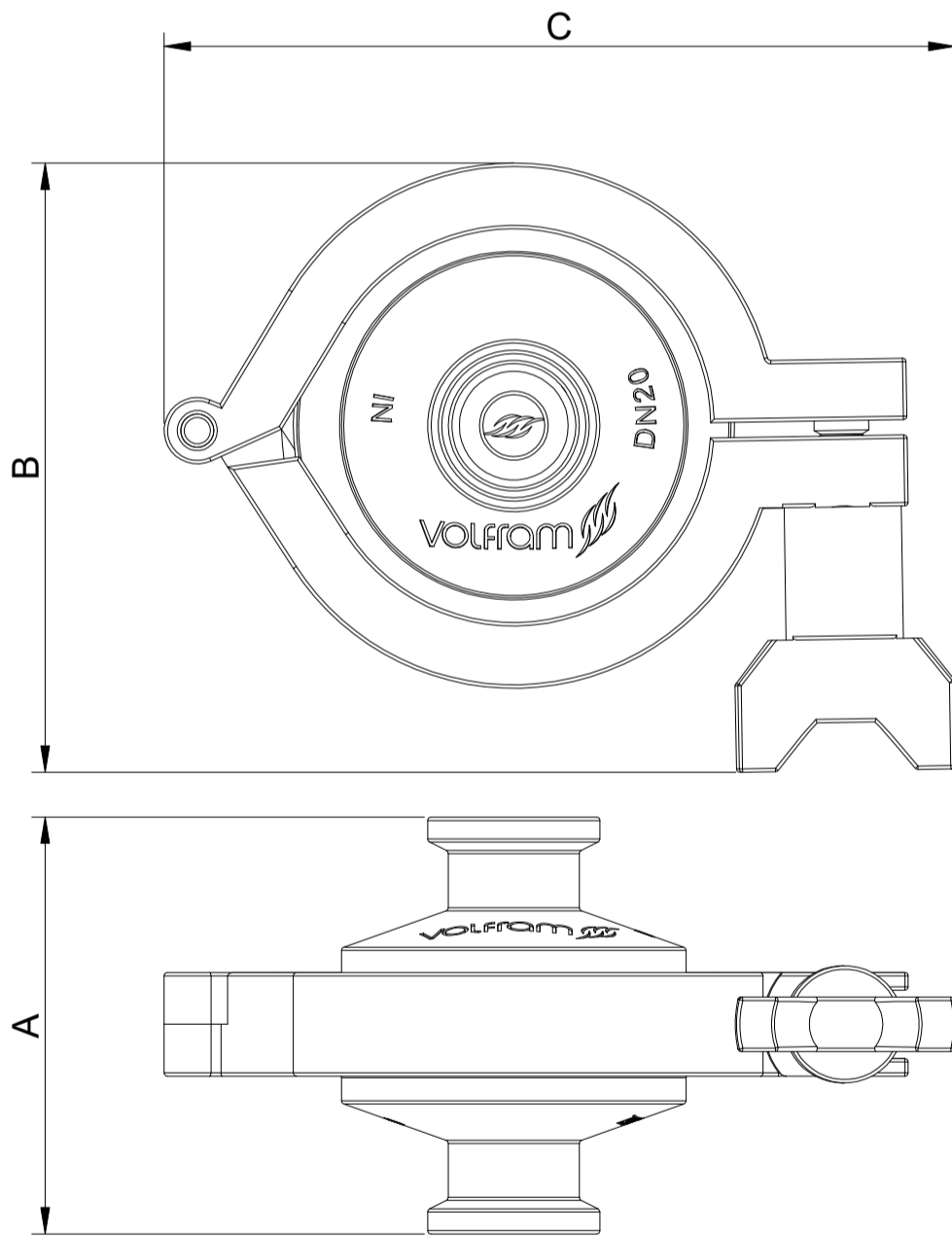

BILL OF MATERIAL

| Sr. No. | Part | Material |
|---------|----------------------|----------|
| 01 | Top Cover | SS 316L |
| 02 | Bottom Cover | SS 316L |
| 03 | Thermostatic Element | SS 316L |
| 04 | Clamp | SS 304 |
| 05 | Gasket | PTFE |
| 06 | Spring | SS 316L |

INSTALLATION :

The steam trap to be fitted vertically with inlet from top, facilitating complete drainage. Ensure that installation is to be done as per the flow direction marked on the body. Do not expose the trap to superheated conditions. Do not depressurize the trap before it cools, this may damage the thermostatic element.

OPERATING CONDITIONS

| End Connection | Maximum Operating Pressure | Maximum Operating Temperature | Hydro Test Pressure |
|----------------|----------------------------|-------------------------------|---------------------|
| Tri Clover | 10 bar(g) | 150 °C | 15 bar(g) |

* NOTE : WE RESERVE THE RIGHT TO CHANGE SPECIFICATIONS WITHOUT PRIOR NOTICE FOR THE DEVELOPMENT AND IMPROVEMENT OF THE PRODUCT.



VOLFRAM SYSTEMS INDIA PVT. LTD.

OFFICE ADDRESS : 402, RUTUVIHAR, VARANASI SOCIETY, WARJE, PUNE, 411058
 FACTORY ADDRESS : D II, BLOCK NO. 58&59- 13/14/15, OPP. SPACO CO., SANT
 DYANESHWAR INDUSTRIAL ESTATE, MOHAN NAGAR, MIDC CHINCHWAD, 411019
 Tel.: +91 9309534688 | Email: steam@volfram.in | www.volfram.in

V2 JAN 2024